



OUID00-1021-0 100
To authenticate this document,
please scan the QR Code.



Republika ng Pilipinas
Kagawaran ng Edukasyon
Tanggapan ng Pangalawang Kalihim

OUA MEMO 00-1021-0100
MEMORANDUM
13 October 2021

TO : REGIONAL DIRECTORS
SCHOOLS DIVISION SUPERINTENDENTS
(Regions and Divisions with Schools Included for the Pilot of Face-to-Face Classes)

ATTENTION : REGIONAL AND DIVISION ENGINEERS

SUBJECT : CONDUCT OF DETAILED ASSESSMENT OF THE READINESS OF SCHOOL FACILITIES FOR PILOT FACE-TO-FACE CLASSES

The Department of Education has already released the initial list of schools that will conduct the pilot implementation of the face-to-face classes on 15 November 2021. The schools were identified and selected through the assistance of the Department of Health (DOH).

To determine the readiness of the school facilities before the opening of classes, Regional and Division Engineers must be mobilized to conduct a detailed assessment of the identified schools using the attached Physical Facilities Assessment Form for Pilot Face-to-Face Classes (Annex A).

The validation report should include the specific actions to be taken by the Division Offices to make the necessary improvements of facilities to meet the standards required by the Inter-Agency Task Force for the Management of Emerging Infectious Diseases (IATF).

Kindly refer to Annex B for data on school facilities for the identified fifty-nine (59) schools based on the latest National School Building Inventory System (NSBI) for your reference.

The attached form must be accomplished and submitted to the Education Facilities Division through Engr. Annabelle R. Pangan, Division Chief, by the end of the month or on 30 October 2021.

For your compliance.

ALAIN DEL B. PASCUA
Undersecretary



Office of the Undersecretary for Administration (OUA)

[Administrative Service (AS), Information and Communications Technology Service (ICTS), Disaster Risk Reduction and Management Service (DRMMS), Bureau of Learner Support Services (BLSS), Baguio Teachers Camp (BTC), Central Security & Safety Office (CSSO)]

Department of Education, Central Office, Meralco Avenue, Pasig City
Rm 519, Mabini Bldg; Mobile: +639260320762; Tel: (+632) 86337203, (+632) 86376207
Email: usec.admin@deped.gov.ph; Facebook/Twitter @depedtayo



Scan this QR Code to view
Videos and Magazines
of Major Programs



Physical Facilities Assessment Form for Pilot Face to Face Classes (Annex A)

Name of School: _____
 School ID: _____
 Address: _____
 Region: _____
 Division: _____
 Date accomplished: _____

SURVEY QUESTIONS	YES	NO	FOR REPAIR	NO. OF UNITS FOR REPAIR	FOR REPLACEMENT	NO. OF UNITS FOR REPLACEMENT	OBSERVATIONS/REMARKS
I. CLASSROOM STRUCTURES							
a. With available seats for every classroom							
i. Available seats are in good condition							
ii. Seats are arranged at least 1-2 meters apart							
b. With working electrical lights in every classroom							
c. With available electric fans in every classroom							
d. With electrical outlets in every classroom							
e. Classrooms are provided with doors and windows							
i. Two (2) sets of doors for each classroom							
ii. Dedicated entrance and exit are properly marked for every classroom							
iii. Windows open and close easily							
f. With markers on the floor for the traffic flow and physical distancing inside the classroom							
g. With directional markers along the hallway indicating the walking direction							
II. SCHOOL COMPOUND							
a. Display of school map at the entrance point indicating the location of the classrooms and traffic flow							
b. With directional markers indicating the traffic flow within the compound							
c. Separate entrance and exit points in the school							
III. WATER AND SANITATION FACILITIES							
a. With available handwashing station:							
i. With available clean and potable water supply							
ii. With working faucets							
b. Handwashing facilities in strategic location							
i. Near the school entrance							
ii. Outside of the buildings							
c. With available toilet facilities:							
i. With working faucets and lavatories							
ii. With available clean and safe water supply							
iii. With toilet bowls in good condition							
OTHER FACILITIES							
1 School Clinic							

SUMMARY OF PHYSICAL FACILITIES REQUIREMENTS

Classrooms	Total No. of Required Classrooms @ 1:15 set-up	Total No. of Usable Classrooms @ 1:15 set-up	Total Remaining No. of Classrooms Required @ 1:15 set-up
Classrooms at 1:15 max of 1:16 per classroom (See attached Classroom Layout)			
Sanitary Facilities	Total No. of Required based on 1:50 learner ratio	Total No. of Usable Facility based on 1 seat:50 learner ratio	Total Remaining Requirements based on 1 seat:50 learner ratio
Toilet Facilities			
Handwashing Facilities			

Inspected by:

Reviewed:

Noted:

DepEd Division Engineer

SGOD Chief

Schools Division Superintendent

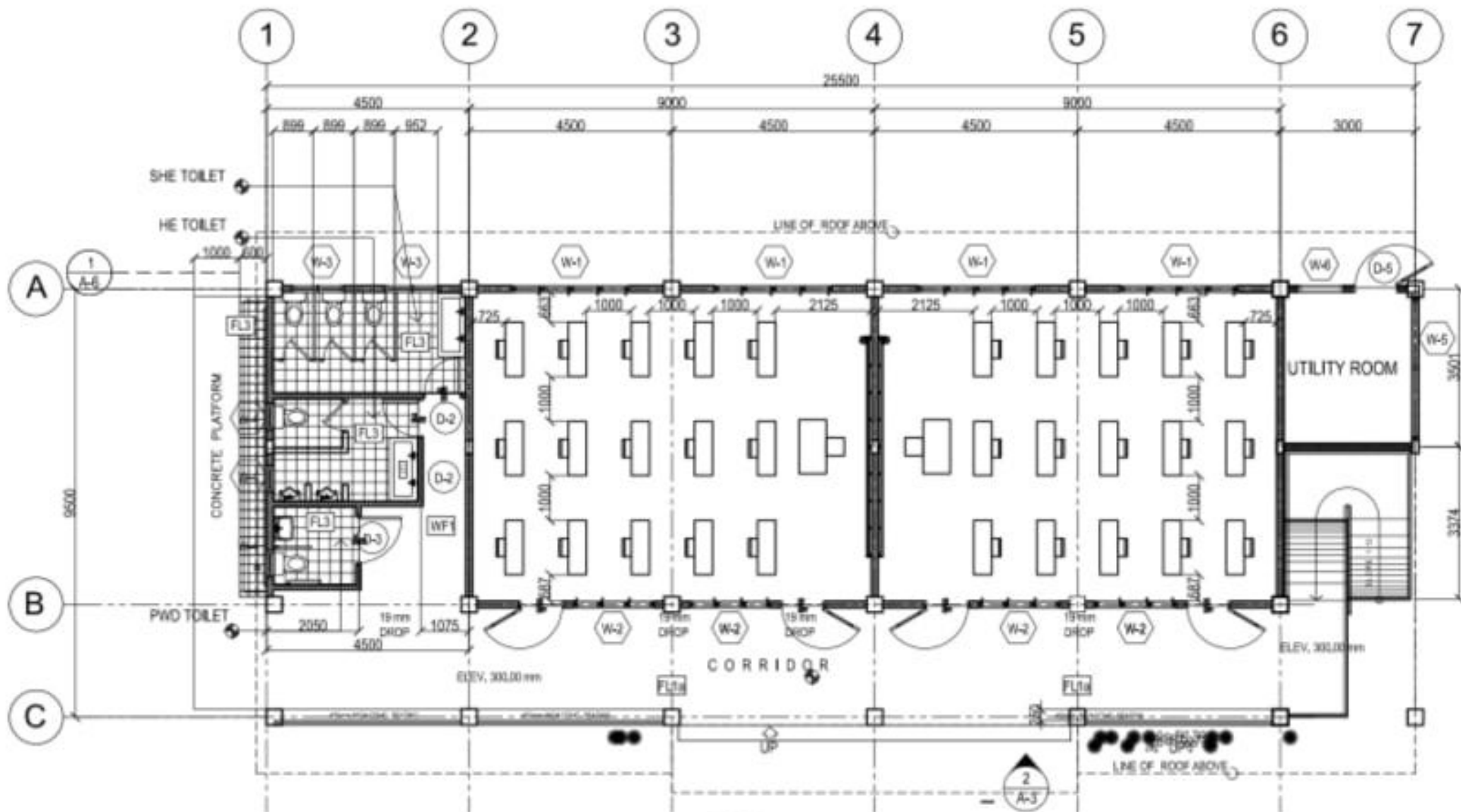

2 FLOOR PLAN
A-2 1:100M SCALE

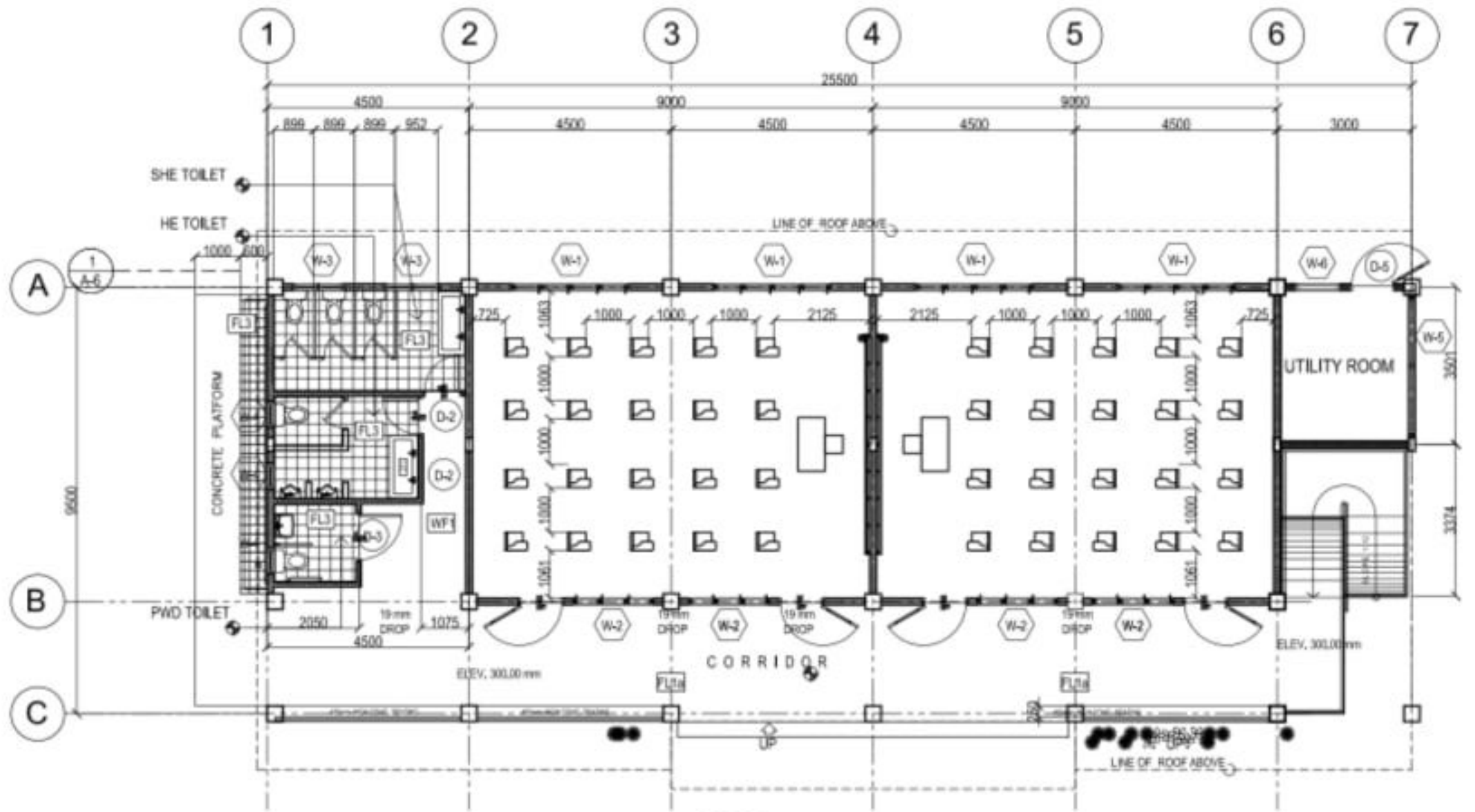

2 FLOOR PLAN
 A-2 1:100M SCALE

Annex B

Region	Division	School ID	School Name	Municipality	Leg District	Barangay	Province	Level	28640	951	1916	965	1110	50	50	519	574	237
									Total Enrollment	Instructional Rooms	Classrooms Requirement	Classrooms Shortage	No. of Toilet Bowls+Urinals	Toilet Requirement	Toilet Shortage	No. of Sink/Washbasin	Hanwashing Requirement	Handwashing Shortage
Region V	Masbate City	113686	Asid Elementary School	CITY OF MASBATE (Capital)	2	ASID	MASBATE	Purely ES	148	0	10	10	7	3	0	0	3	3
Region V	Masbate City	113711	Sinalongan Elementary School	CITY OF MASBATE (Capital)	2	SINALONGAN	MASBATE	Purely ES	248	7	17	10	6	5	0	5	5	0
Region V	Masbate City	231501	Gutusan Elementary School	CITY OF MASBATE (Capital)	2	IGANG	MASBATE	Purely ES	63	7	4	-3	3	1	0	3	1	0
Region V	Masbate	309908	Mary Perpetua E. Brioso National High School	MILAGROS	2	TIGBAO	MASBATE	JHS with SHS	747	14	50	36	28	15	0	26	15	0
Region VI	Aklan	501182	Laserna Integrated School	NABAS	2	LASERNA	AKLAN	All Offering (K to 12)	723	14	48	34	15	14	0	15	14	0
Region VI	Antique	114990	Igsoro ES	BUGASONG	0	IGSORO	ANTIQUE	Purely ES	232	7	16	9	10	5	0	9	5	0
Region VI	Antique	178516	Mayabay Elementary School	BARBAZA	0	MAYABAY	ANTIQUE	Purely ES	75	4	5	1	2	2	0	0	2	2
Region VII	Cebu	302926	Busay National High School	MOALBOAL	7	BUSAY	CEBU	JHS with SHS	247	13	17	4	0	5	5	0	5	5
Region VII	Cebu	119604	Basak Elementary School	SAMBOAN	2	BASAK	CEBU	Purely ES	116	10	8	-2	14	2	0	8	2	0
Region VII	Cebu	119444	Mahanlud ES	MALABUYOC	7	MAHANLUD	CEBU	Purely ES	89	6	6	0	10	2	0	2	2	0
Region VII	Cebu	119021	Cabagdalan ES	BALAMBAN	3	CABAGDALAN	CEBU	Purely ES	118	7	8	1	14	2	0	8	2	0
Region VII	Bogo City	119106	Combado ES	CITY OF BOGO	4	GUADALUPE	CEBU	Purely ES	153	4	10	6	5	3	0	1	3	2
Region VII	Bogo City	119113	Siocon ES	CITY OF BOGO	4	SIOCON	CEBU	Purely ES	235	12	16	4	8	5	0	8	5	0
Region VII	Bogo City	302937	Odlot NHS	CITY OF BOGO	4	ODLOT	CEBU	JHS with SHS	286	14	19	5	14	6	0	7	6	0
Region VII	Bogo City	302933	Don Potenciano Catarata MNHS	CITY OF BOGO	4	GUADALUPE	CEBU	JHS with SHS	330	15	22	7	18	7	0	5	7	2
Region VII	Bogo City	312405	Bartolome C.Pianar MNHS	CITY OF BOGO	4	DAKIT	CEBU	JHS with SHS	197	11	13	2	0	4	4	0	4	4
Region VII	Cebu	187017	Luyongbaybay PS	BANTAYAN	4	LUYONGBAYBAY	CEBU	Purely ES	238	12	16	4	9	5	0	1	5	4
Region VII	Cebu	312426	Cañang-Marcelo Luna NHS	OSLOB	2	CAÑANG	CEBU	JHS with SHS	285	13	19	6	15	6	0	0	6	6
Region VII	Cebu	303073	Pilar NHS	PILAR	5	VILLAHERMOSA	CEBU	JHS with SHS	536	19	36	17	23	11	0	0	11	11
Region IX	Zamboanga Sibugay	125837	Siay CES	SIAY	2	LOGPOND	ZAMBOANGA SIBUGAY	Purely ES	725	2	48	46	1	15	14	0	15	15
Region IX	Zamboanga Sibugay	125838	Sibuguey ES	SIAY	2	SIBUGUEY	ZAMBOANGA SIBUGAY	Purely ES	116	8	8	0	9	2	0	1	2	1
Region IX	Zamboanga Sibugay	125839	Siloh ES	SIAY	2	SILOH	ZAMBOANGA SIBUGAY	Purely ES	176	7	12	5	11	4	0	1	4	3
Region IX	Pagadian City	303904	Manga NHS	PAGADIAN CITY (Capital)	1	MANGA	ZAMBOANGA DEL SUR	JHS with SHS	321	15	22	7	8	6	0	2	6	4
Region IX	Pagadian City	126065	Manga ES	PAGADIAN CITY (Capital)	1	MANGA	ZAMBOANGA DEL SUR	Purely ES	344	14	23	9	13	7	0	13	7	0
Region IX	Pagadian City	303901	Lala National High School	PAGADIAN CITY (Capital)	1	LALA	ZAMBOANGA DEL SUR	JHS with SHS	415	26	28	2	16	8	0	13	8	0
Region IX	Pagadian City	126073	Lala ES	PAGADIAN CITY (Capital)	1	LALA	ZAMBOANGA DEL SUR	Purely ES	317	12	21	9	15	6	0	11	6	0
Region IX	Pagadian City	126064	Lenienza ES	PAGADIAN CITY (Capital)	1	LENIENZA	ZAMBOANGA DEL SUR	Purely ES	689	17	46	29	24	14	0	19	14	0
Region IX	Zamboanga City	126136	Cadalagan ES	ZAMBOANGA CITY	1	LA PAZ	ZAMBOANGA DEL SUR	Purely ES	472	13	32	19	21	9	0	4	9	5
Region IX	Zamboanga City	303937	Tolosa NHS	ZAMBOANGA CITY	2	TOLOSA	ZAMBOANGA DEL SUR	JHS with SHS	649	16	43	27	13	13	0	1	13	12
Region IX	Zamboanga City	126174	Sinunuk ES	ZAMBOANGA CITY	2	TUMALUTAB	ZAMBOANGA DEL SUR	Purely ES	64	7	4	-3	1	1	0	0	1	1
Region IX	Zamboanga City	303931	Sibulao NHS	ZAMBOANGA CITY	2	SIBULAO (CARUAN)	ZAMBOANGA DEL SUR	JHS with SHS	500	13	33	20	10	10	0	0	10	10
Region IX	Zamboanga City	501110	Manalipa IS	ZAMBOANGA CITY	2	MANALIPA	ZAMBOANGA DEL SUR	All Offering (K to 12)	598	11	40	29	9	12	3	1	12	11
Region IX	Zamboanga City	126168	Pasilmanta ES	ZAMBOANGA CITY	2	PASILMANTA (SACOL ISLAND)	ZAMBOANGA DEL SUR	Purely ES	437	10	29	19	6	9	3	1	9	8
Region IX	Zamboanga City	126175	Tumalutab ES	ZAMBOANGA CITY	2	TUMALUTAB	ZAMBOANGA DEL SUR	Purely ES	366	6	25	19	9	7	0	1	7	6
Region IX	Zamboanga City	126159	Landang Gua ES	ZAMBOANGA CITY	2	LANDANG GUA	ZAMBOANGA DEL SUR	Purely ES	589	14	39	25	11	12	1	1	12	11
Region IX	Zamboanga City	314803	Arena Blanco NHS- Landang Gua Annex	ZAMBOANGA CITY	2	LANDANG GUA	ZAMBOANGA DEL SUR	JHS with SHS	935	0	62	62	3	19	16	0	19	19
Region IX	Zamboanga City	126167	Panganak ES	ZAMBOANGA CITY	2	MANALIPA	ZAMBOANGA DEL SUR	Purely ES	200	6	13	7	8	4	0	2	4	2
Region IX	Zamboanga del Sur	125279	Blancia CES	MOLAVE	1	BLANCIA	ZAMBOANGA DEL SUR	Purely ES	320	22	21	-1	32	6	0	22	6	0
Region IX	Zamboanga del Sur	303817	Sominot National High School	SOMINOT (DON MARIANO MARCOS)	1	POBLACION	ZAMBOANGA DEL SUR	JHS with SHS	1295	49	86	37	76	26	0	9	26	17
Region IX	Zamboanga del Sur	303816	Parasan National High School	MOLAVE	1	PARASAN	ZAMBOANGA DEL SUR	JHS with SHS	338	12	23	11	12	7	0	1	7	6
Region IX	Zamboanga del Sur	125415	Tabina CES	TABINA	2	POBLACION	ZAMBOANGA DEL SUR	Purely ES	852	26	57	31	30	17	0	4	17	13
Region IX	Zamboanga del Sur	303784	Kumalarang NHS	KUMALARANG	2	POBLACION	ZAMBOANGA DEL SUR	JHS with SHS	1549	46	103	57	36	31	0	8	31	23
Region IX	Zamboanga del Sur	303778	Guipos NHS	GUIPOS	2	POBLACION (GUIPOS)	ZAMBOANGA DEL SUR	JHS with SHS	1553	64	104	40	115	31	0	64	31	0
Region IX	Zamboanga Sibugay	125777	San Vicente ES	PAYAO	1	SAN VICENTE (BINANGONAN)	ZAMBOANGA SIBUGAY	Purely ES	95	6	6	0	7	2	0	2	2	0
Region X	Lanao del Norte	126977	Dalama CES	BAROY	1	DALAMA	LANAO DEL NORTE	Purely ES	385	14	26	12	28	8	0	12	8	0
Region X	Lanao del Norte	126938	Babalaya ES	BACOLOD	1	BABALAYA	LANAO DEL NORTE	Purely ES	127	5	9	4	8	3	0	4	3	0
Region X	Lanao del Norte	127096	Napo ES	LINAMON	1	NAPO	LANAO DEL NORTE	Purely ES	167	11	11	0	7	3	0	0	3	3
Region X	Lanao del Norte	501600	Masibay Integrated School	NUNUNGAN	2	MASIBAY	LANAO DEL NORTE	ES and JHS (K to 10)	410	8	27	19	13	8	0	2	8	6
Region X	Lanao del Norte	500431	Tambacon Integrated School	MAGSAYSAY	2	TAMBACON	LANAO DEL NORTE	ES and JHS (K to 10)	249	2	17	15	12	5	0	26	5	0
Region X	Lanao del Norte	304011	Marcela T. Mabanta NHS	KAUSWAGAN	1	LIBERTAD	LANAO DEL NORTE	JHS with SHS	1449	30	97	67	39	29	0	33	29	0
Region XII	Sarangani	500255	Pag-asa IS	ALABEL (Capital)	0	PAG-ASA	SARANGANI	All Offering (K to 12)	558	16	37	21	11	11	0	6	11	5
Region XII	Sarangani	304529	James L. Chiongbian National Trade School	KIAMBA	0	KLING (LUMIT)	SARANGANI	JHS with SHS	1735	83	116	33	55	35	0	51	35	0
Region XII	Sarangani	304523	Colon NHS	MAASIM	0	COLON	SARANGANI	JHS with SHS	1776	69	119	50	85	36	0	29	36	7
Region XII	Sarangani	304532	Maguling NHS	MAITUM	0	MAGULING	SARANGANI	JHS with SHS	922	36	62	26	41	18	0	30	18	0
Region XII	Sarangani	500272	Daan Suyan Integrated School	MALAPATAN	0	DAAN SUYAN	SARANGANI	All Offering (K to 12)	868	27	58	31	48	17	0	16	17	1
Region XII	Sarangani	130570	Baliton Elementary School	MALUNGON	0	KINABALAN	SARANGANI	Purely ES	22	7	2	-5	2	0	0	0	0	0
Region XII	Sarangani	500715	Lamlifew Integrated School	MALUNGON	0	DATAL TAMPAL	SARANGANI	ES and JHS (K to 10)	329	8	22	14	18	7	0	2	7	5
Region XII	Kidapawan City	304668	Paco National High School	CITY OF KIDAPAWAN (Capital)	2	PACO	NORTH COTABATO	JHS with SHS	473	24	32	8	46	9	0	29	9	0
Region XII	North Cotabato	130108	Bato ES	MAKILALA	2	BATO	NORTH COTABATO	Purely ES	189	0	13	13	0	4	4	0	4	4

